

CRSH8-40FP
CRSH8-60FP
CRSH8-100FP

SILICON SCHOTTKY RECTIFIERS
8.0 AMP, 40 THRU 100 VOLT



TO-220FP-2 CASE



www.centrasemi.com

DESCRIPTION:

The CENTRAL SEMICONDUCTOR CRSH8-40FP series are silicon Schottky rectifiers designed for fast switching applications requiring a low forward voltage drop.

MARKING: FULL PART NUMBER

FEATURES:

- High reliability
- High current capability
- UL flammability classification 94V-O
- Low power loss, high efficiency
- Low forward voltage
- High surge capacity
- High voltage

MAXIMUM RATINGS: ($T_C=25^\circ\text{C}$ unless otherwise noted)

	SYMBOL	CRSH8 -40FP	CRSH8 -60FP	CRSH8 -100FP	UNITS
Peak Repetitive Reverse Voltage	V_{RRM}	40	60	100	V
DC Blocking Voltage	V_R	40	60	100	V
RMS Reverse Voltage	$V_{R(RMS)}$	28	42	70	V
Average Forward Current ($T_C=100^\circ\text{C}$)	I_O		8.0		A
Peak Forward Surge Current ($t_p=8.3\text{ms}$)	I_{FSM}		150		A
Critical Rate of Rise of Reverse Voltage	dV/dt		10,000		V/ μs
Operating and Storage Junction Temperature	T_J, T_{stg}		-65 to +150		$^\circ\text{C}$
Typical Thermal Resistance	θ_{JA}		50		$^\circ\text{C/W}$
Typical Thermal Resistance	θ_{JC}		4.0		$^\circ\text{C/W}$

ELECTRICAL CHARACTERISTICS: ($T_C=25^\circ\text{C}$ unless otherwise noted)

SYMBOL	TEST CONDITIONS	CRSH8-40FP		CRSH8-60FP		CRSH8-100FP		UNITS
		TYP	MAX	TYP	MAX	TYP	MAX	
I_R	$V_R=\text{Rated } V_{RRM}$	-	100	-	100	-	100	μA
I_R	$V_R=\text{Rated } V_{RRM}, T_C=125^\circ\text{C}$	-	15	-	15	-	15	mA
V_F	$I_F=8.0\text{A}$	-	0.65	-	0.75	-	0.85	V
V_F	$I_F=8.0\text{A}, T_C=125^\circ\text{C}$	-	0.57	-	0.65	-	0.75	V
V_F	$I_F=16\text{A}$	-	0.84	-	0.95	-	1.1	V
V_F	$I_F=16\text{A}, T_C=125^\circ\text{C}$	-	0.72	-	0.85	-	1.0	V
C_J	$V_R=4.0\text{V}, f=1.0\text{MHz}$	300	-	300	-	300	-	pF

CRSH8-40FP
 CRSH8-60FP
 CRSH8-100FP

SILICON SCHOTTKY RECTIFIERS
 8.0 AMP, 40 THRU 100 VOLT



TO-220FP-2 CASE - MECHANICAL OUTLINE

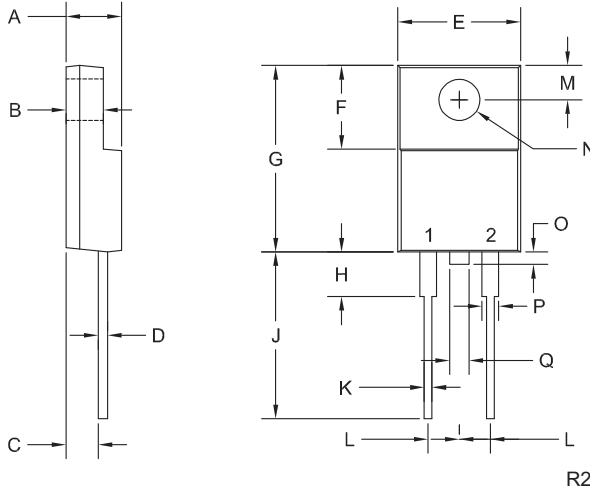

SYMBOL	INCHES		MILLIMETERS	
	MIN	MAX	MIN	MAX
A	-	0.189	-	4.80
B	-	0.123	-	3.12
C	0.098	0.114	2.50	2.90
D	-	0.032	-	0.81
E	-	0.406	-	10.31
F	0.248	0.272	6.30	6.90
G	0.583	0.606	14.80	15.40
H	-	0.161	-	4.10
J	0.512	0.543	13.00	13.80
K	-	0.035	-	0.90
L	0.100		2.55	
M	0.100	0.112	2.55	2.85
N (DIA)	0.118	0.134	3.00	3.40
O	-	0.063	-	1.60
P	-	0.055	-	1.40
Q	-	0.071	-	1.80

TO-220FP-2 (REV: R2)

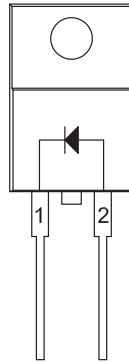

LEAD CODE:

- 1) Cathode
- 2) Anode

MARKING:

FULL PART NUMBER

R2 (9-September 2013)