

CMSD6263
 CMSD6263A
 CMSD6263C
 CMSD6263S

**SURFACE MOUNT
 SILICON SCHOTTKY DIODES**



www.centrasemi.com

DESCRIPTION:

The CENTRAL SEMICONDUCTOR CMSD6263 Series types are High Voltage Silicon Schottky diodes, epoxy molded in a SUPERmini™ surface mount package, designed for low current fast switching applications requiring a low forward voltage drop.

SUPERmini™



SOT-323 CASE

The following configurations are available:

CMSD6263: SINGLE
CMSD6263A: DUAL, COMMON ANODE
CMSD6263C: DUAL, COMMON CATHODE
CMSD6263S: DUAL, IN-SERIES

MARKING CODE: 76D
MARKING CODE: 98D
MARKING CODE: 97D
MARKING CODE: 96D

MAXIMUM RATINGS: (T_A=25°C)

Peak Repetitive Reverse Voltage
 Continuous Forward Current
 Peak Forward Surge Current, tp=1.0s
 Power Dissipation
 Operating and Storage Junction Temperature
 Thermal Resistance

SYMBOL

V_{RRM} 70
 I_F 15
 I_{FSM} 50
 P_D 275
 T_J, T_{stg} -65 to +150
 Θ_{JA} 455

UNITS

V
 mA
 mA
 mW
 °C
 °C/W

ELECTRICAL CHARACTERISTICS PER DIODE: (T_A=25°C unless otherwise noted)

SYMBOL	TEST CONDITIONS	MIN	TYP	MAX	UNITS
I _R	V _R =50V		98	200	nA
BV _R	I _R =10μA	70			V
V _F	I _F =1.0mA		395	410	mV
C _T	V _R =0, f=1.0MHz			2.0	pF
t _{rr}	I _R =I _F =10mA, I _{rr} =1.0mA, R _L =100Ω			5.0	ns

CMSD6263
 CMSD6263A
 CMSD6263C
 CMSD6263S



**SURFACE MOUNT
 SILICON SCHOTTKY DIODES**

SOT-323 CASE - MECHANICAL OUTLINE

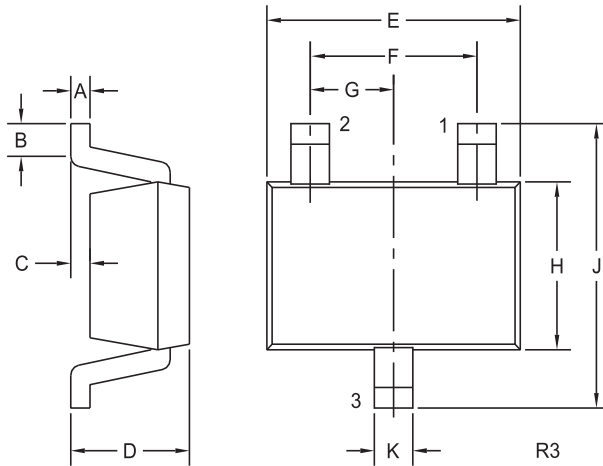

SYMBOL	DIMENSIONS			
	INCHES		MILLIMETERS	
	MIN	MAX	MIN	MAX
A	0.002	0.008	0.05	0.20
B	0.004	-	0.10	-
C	-	0.004	-	0.10
D	0.031	0.043	0.80	1.10
E	0.071	0.087	1.80	2.20
F	0.051		1.30	
G	0.026		0.65	
H	0.045	0.053	1.15	1.35
J	0.079	0.087	2.00	2.20
K	0.008	0.016	0.20	0.40

SOT-323 (REV: R3)

PIN CONFIGURATIONS

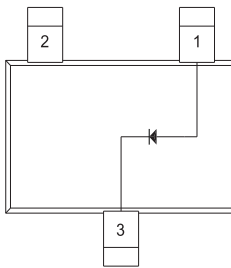

CMSD6263

LEAD CODE:

- 1) Anode
- 2) NC
- 3) Cathode

MARKING CODE: 76D

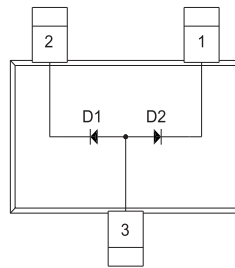

CMSD6263A

LEAD CODE:

- 1) Cathode D2
- 2) Cathode D1
- 3) Anode D1, D2

MARKING CODE: 98D

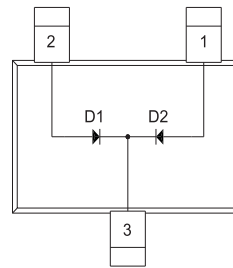

CMSD6263C

LEAD CODE:

- 1) Anode D2
- 2) Anode D1
- 3) Cathode D1, D2

MARKING CODE: 97D

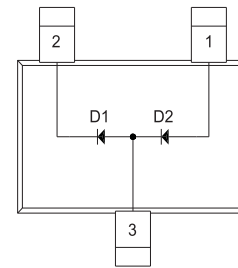

CMSD6263S

LEAD CODE:

- 1) Anode D2
- 2) Cathode D1
- 3) Anode D1, Cathode D2

MARKING CODE: 96D

R3 (8-February 2010)