

# Schottky Barrier Diode

**RB078B30S**

**●Applications**

Switching power supply

**●Features**

- 1) Power mold type.(CPD)
- 2) High reliability
- 3) Low  $I_R$

**●Construction**

Silicon epitaxial planer

**●Dimensions (Unit : mm)**

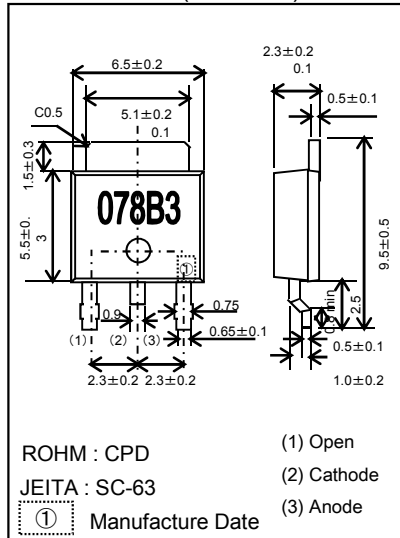

**●Land size figure (Unit : mm)**

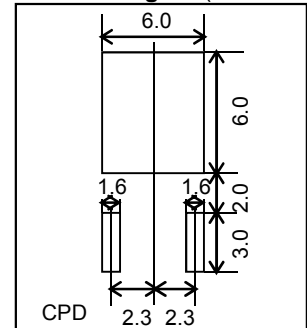

**●Structure**

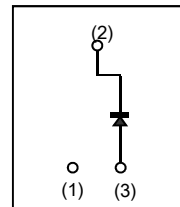

**●Taping dimensions (Unit : mm)**

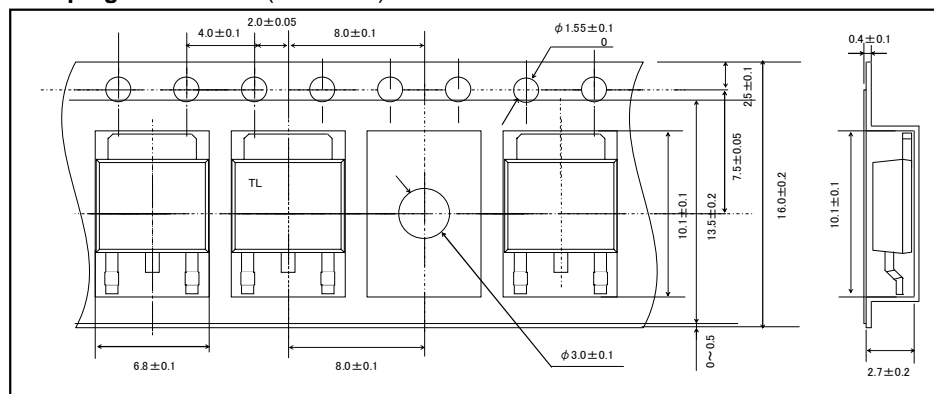

**●Absolute maximum ratings (Tc=25°C)**

Parameter	Symbol	Limits	Unit
Reverse voltage (repetitive peak)	$V_{RM}$	30	V
Reverse voltage (DC)	$V_R$	30	V
Average rectified forward current (*1)	$I_o$	5	A
Forward current surge peak (60Hz · 1cyc)	$I_{FSM}$	40	A
Junction temperature	$T_j$	150	°C
Storage temperature	$T_{stg}$	-55 to +150	°C

(\*1) Business frequencies, Rating of R-load, Tc=95°C Max.

**●Electrical characteristics (Tj=25°C)**

Parameter	Symbol	Min.	Typ.	Max.	Unit	Conditions
Forward voltage	$V_F$	-	-	0.72	V	$I_F=5.0A$
Reverse current	$I_R$	-	-	5	μA	$V_R=30V$

