

1A Avg.

200 Volts

FRED

10ERB20

■最大定格 Maximum Ratings

Item	Symbol	Conditions	Unit
くり返しピーク逆電圧 Repetitive Peak Reverse Voltage	$V_{RRM}$	200	V
平均整流電流 Average Rectified Forward Current	$I_O$	50Hz, 正弦半波通電抵抗負荷 50Hz Half Sine Wave Resistive Load	$T_a=50^{\circ}C^{*1}$ : 1 A $T_a=27^{\circ}C^{*2}$ : 0.9 A
実効順電流 R.M.S. Forward Current	$I_{F(RMS)}$		1.57 A
サージ順電流 Surge Forward Current	$I_{FSM}$	45 50Hz正弦半波, 1サイクル, 非くり返し 50Hz Half Sine Wave, 1cycle, Non-repetitive	A
動作接合温度範囲 Operating Junction Temperature Range	$T_{jw}$		-40~+150 $^{\circ}C$
保存温度範囲 Storage Temperature Range	$T_{stg}$		-40~+150 $^{\circ}C$

■OUTLINE DRAWING(mm)

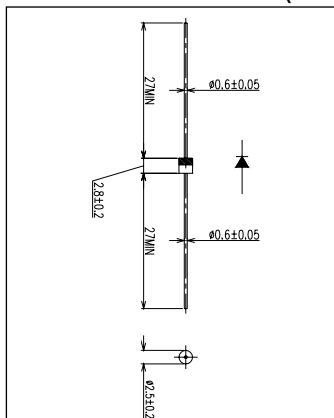

■電氣的・熱的特性 Electrical/Thermal Characteristics

Item	Symbol	Conditions	Min.	Typ.	Max.	Unit
ピーク逆電流 Peak Reverse Current	$I_{RM}$	$T_j=25^{\circ}C, V_{RM}=V_{RRM}$	—	—	10	$\mu A$
ピーク順電圧 Peak Forward Voltage	$V_{FM}$	$T_j=25^{\circ}C, I_{FM}=1A$	—	—	1.03	V
逆回復時間 Reverse Recovery Time	$t_{rr}$	$I_{FM}=1A, -di/dt=50 A/\mu s, T_j=25^{\circ}C$	—	—	60	ns
熱抵抗 Thermal Resistance	$R_{th(j-a)}$	接合部・周囲間 Junction to Ambient	—	—	100	$^{\circ}C/W$
			—	—	140	$^{\circ}C/W$

\*1: プリント基板実装 / P.C. Board mounted (L=3mm, Print Lands=7×7 mm, Both Sides)  
\*2: 単体フィン無し / Without Fin or P.C. Board mounted

■定格・特性曲線

