

# RB500V-40

## ■ Features

- Small surface mounting type.(UMD2)
- Low IR.(IR = 70 nA Typ.)
- High reliability.

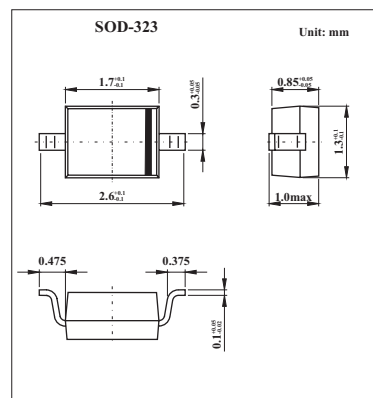

## ■ Absolute Maximum Ratings Ta = 25°C

Characteristic	Symbol	Limits	Unit
Peak reverse voltage	V <sub>RM</sub>	45	V
DC reverse Volatge	V <sub>R</sub>	40	V
Mean rectifying current	I <sub>o</sub>	0.1	A
Peak forwrad surge current*	I <sub>FSM</sub>	1	A
Junction temperature	T <sub>j</sub>	125	°C
Storage temperature	T <sub>stg</sub>	-40 to +125	°C

\*60Hz for 1

## ■ Electrical Characteristics Ta = 25°C

Characteristic	Symbol	Condition	Min	Typ	Max	Unit
Forward Voltage	V <sub>F</sub>	I <sub>F</sub> = 10 mA			0.45	V
Reverse current	I <sub>R</sub>	V <sub>R</sub> = 10 V			1	μ A
Capacitance between terminals	C <sub>T</sub>	V <sub>R</sub> = 10 V, f = 1 MHz		6.0		pF