

## Features

- Schottky barrier diodes
- Low forward voltage drop
- Low leakage current
- Moisture sensitivity: level 1, per J-STD-020
- Solder dip 260 °C, 10 s
- Low profile

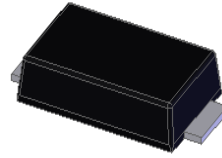

GOODARK: eSGB

## TYPICAL APPLICATIONS

For use of fast switching in RF module, lighting, cellular phone, portable device, power supplies, and other consumer applications.

MAXIMUM RATINGS (TA = 25 °C unless otherwise noted)												
PARAMETER	SYMBOL	LS22N	LS22NS	LS24	LS24N	LS26	LS27	LS2BH	LS2B1H	LS2B5H	LS2CH	UNIT
Maximum repetitive peak reverse voltage	V <sub>RRM</sub>	20	20	40	40	60	70	100	110	150	200	V
Maximum RMS voltage	V <sub>RMS</sub>	14	14	28	28	42	49	70	77	105	140	V
Maximum DC blocking voltage	V <sub>DC</sub>	20	20	40	40	60	70	100	110	150	200	V
Maximum average forward rectified current	I <sub>F(AV)</sub>	2.0										A
Peak forward surge current 8.3 ms single half sine-wave superimposed on rated load	I <sub>FSM</sub>	50										A
Operating junction and storage temperature range	T <sub>J</sub> , T <sub>STG</sub>	- 55 to + 125				- 55 to + 150			- 55 to + 175			°C

ELECTRICAL CHARACTERISTICS (TA = 25 °C unless otherwise noted)														
PARAMETER	TEST CONDITIONS	SYMBOL	LS22N	LS22NS	LS24	LS24N	LS26	LS27	LS2BH	LS2B1H	LS2B5H	LS2CH	UNIT	
Maximum instantaneous forward voltage	IF=2A, Tj=25	VF	0.43	0.45	0.52	0.7	0.65	0.79	0.8	0.8	0.85	0.85	Volts	
	IF=2A, Tj=125		TBD											
Maximum DC reverse current at rated DC blocking voltage	TA=25	IR	0.5										mA	
	TA=125		TBD											
Typical junction capacitance	4.0 V, 1 MHz	C <sub>J</sub>	TBD						TBD					pF
Typical thermal resistance	junction to lead	R <sub>θJL</sub>	TBD						TBD					°C/W

## RATINGS AND CHARACTERISTICS CURVES

(TBD)

## PACKAGE OUTLINE DIMENSIONS (in millimeters)

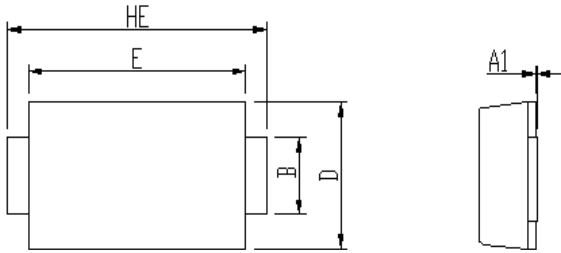

DIM	Unit: mm		Unit: inch	
	MIN	MAX	MIN	MAX
A	0.92	1.08	0.036	0.043
A1	0	0.1	0.000	0.004
B	1.25	1.45	0.049	0.057
C	0.1	0.25	0.004	0.010
D	2.6	2.8	0.102	0.110
E	4.1	4.3	0.161	0.169
L	0.8	1.0	0.031	0.039
HE	4.8	5.2	0.189	0.205

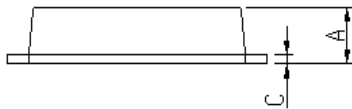

Soldering footprint

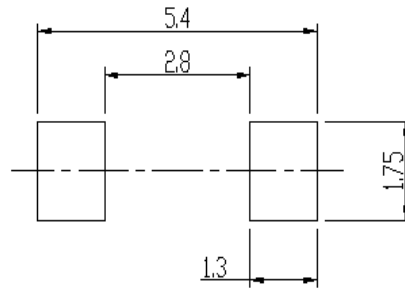
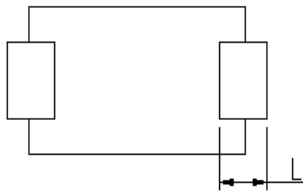

## PACKING INFORMATION

Packing quantities:

3000 pcs/Reel , 12mm Tape, 13" Reel

Tape & Reel Specification

