

Features

- Glass passivated fast recovery rectifiers
- Ideal for automated placement
- Low forward voltage drop
- Low leakage current
- Moisture sensitivity: level 1, per J-STD-020
- Solder dip 260 °C, 10 s
- Low profile

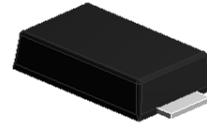

eSGB
(SMAF)

TYPICAL APPLICATIONS

For use of general purpose rectification in lighting, cellular phone, portable device, power supplies, and other consumer applications.

MAXIMUM RATINGS (TA = 25 °C unless otherwise noted)				
PARAMETER	SYMBOL	L2F6	L2F7	UNIT
Maximum repetitive peak reverse voltage	V _{RRM}	800	1000	V
Maximum RMS voltage	V _{RMS}	560	700	V
Maximum DC blocking voltage	V _{DC}	800	1000	V
Maximum average forward rectified current	I _{F(AV)}	1.0		A
Peak forward surge current 8.3 ms single half sine-wave superimposed on rated load	I _{FSM}	50		A
Operating junction and storage temperature range	T _J , T _{STG}	- 55 to + 150		°C

ELECTRICAL CHARACTERISTICS (TA = 25 °C unless otherwise noted)					
PARAMETER	TEST CONDITIONS	SYMBOL	L2F6	L2F7	UNIT
Maximum instantaneous forward voltage	I _F =2A, T _J =25	V _F	1.3		Volts
Maximum DC reverse current at rated DC blocking voltage	TA=25	I _R	5.0		μA
	TA=125		50		
Typical reverse recovery time	I _F =0.5A, I _R =1.0A, I _{rr} =0.25A	t _{rr}	500		nS
Typical junction capacitance	4.0 V, 1 MHz	C _J	11		pF
Typical thermal resistance	junction to mount	R _{θJM} ¹⁾	12		°C/W

Note1: Thermal resistance from junction to mount, mounted on PCB with 8.0x8.0mm copper pads



L2F6 thru L2F7

Surface Mount Glass Passivated Rectifier
Reverse Voltage 800~1000V Forward Current 2A

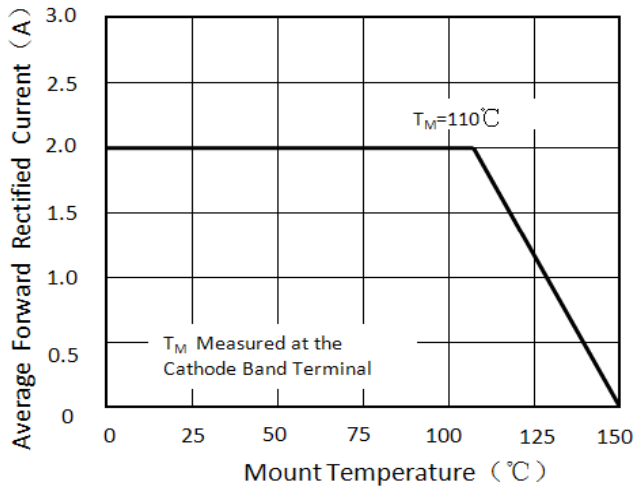

Figure 1. Forward Current Derating Curve

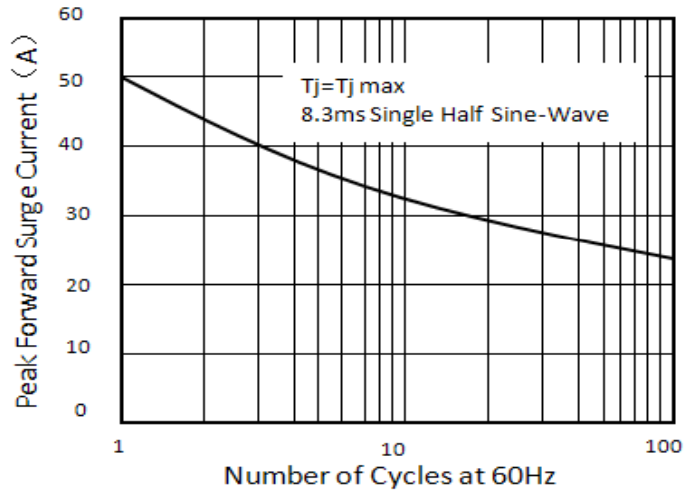

Figure 2. Maximum Non-Repetitive Peak Forward Surge Current

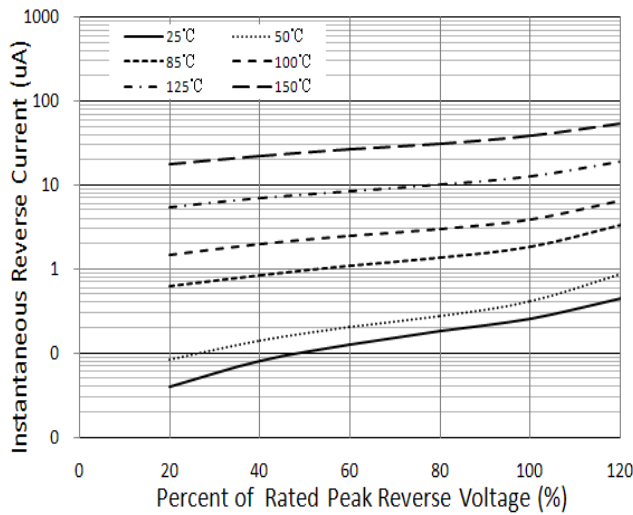

Figure 3. Typical Reverse Characteristics

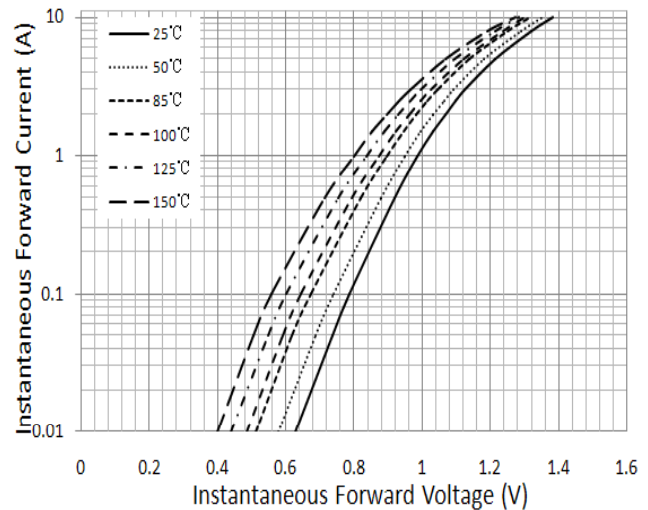

Figure 4. Typical Instantaneous Forward Characteristic

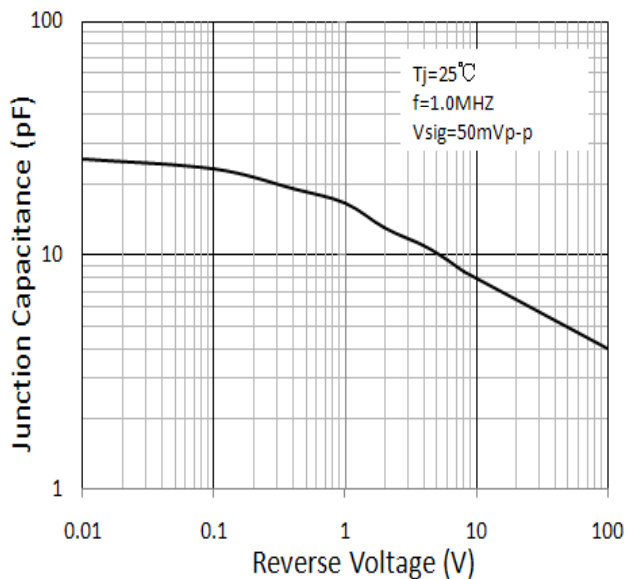
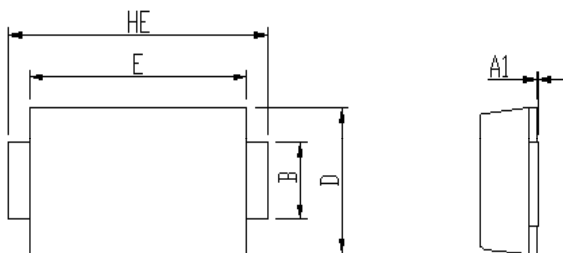
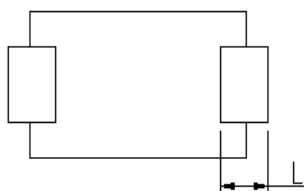
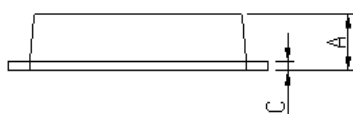

Figure 5. Typical Junction Capacitance

PACKAGE OUTLINE DIMENSIONS (in millimeters)



DIM	Unit: mm		Unit: inch	
	MIN	MAX	MIN	MAX
A	0.92	1.08	0.036	0.043
A1	0	0.1	0.000	0.004
B	1.25	1.45	0.049	0.057
C	0.1	0.25	0.004	0.010
D	2.6	2.8	0.102	0.110
E	4.1	4.3	0.161	0.169
L	0.7	1.1	0.028	0.043
HE	4.8	5.2	0.189	0.205



Soldering footprint

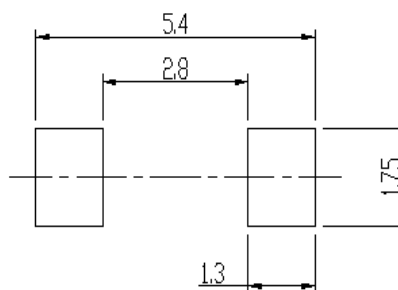

PACKING INFORMATION

Packing quantities:

3000 pcs/Reel , 12mm Tape, 13" Reel

Tape & Reel Specification

