



Micro Commercial Components



Micro Commercial Components  
 20736 Marilla Street Chatsworth  
 CA 91311  
 Phone: (818) 701-4933  
 Fax: (818) 701-4939

**2SC4097-P**  
**2SC4097-Q**  
**2SC4097-R**

**Features**

- Lead Free Finish/RoHS Compliant ("P" Suffix designates RoHS Compliant. See ordering information)
- High  $I_{Cmax}$ .  $I_{Cmax}=0.5A$
- Low  $V_{CE(SAT)}$ . Optimal for low voltage operation.
- Epoxy meets UL 94 V-0 flammability rating
- Moisture Sensitivity Level 1

**Maximum Ratings**

Symbol	Rating	Rating	Unit
$V_{CEO}$	Collector-Emitter Voltage	32	V
$V_{CBO}$	Collector-Base Voltage	40	V
$V_{EBO}$	Emitter-Base Voltage	5	V
$I_C$	Collector Current	500	mA
$P_C$	Collector power dissipation	200	mW
$T_J, T_{STG}$	Junction and Storage Temperature	-55 to +150	°C

**Electrical Characteristics @ 25°C Unless Otherwise Specified**

Symbol	Parameter	Min	Typ	Max	Units
$V_{(BR)CBO}$	Collector -base breakdown voltage ( $I_C=100\mu A, I_E=0$ )	40			V
$V_{(BR)CEO}$	Collector-emitter breakdown voltage ( $I_C=1mA, I_B=0$ )	32			V
$V_{(BR)EBO}$	Emitter-base breakdown voltage ( $I_E=100\mu A, I_C=0$ )	5			V
$I_{CBO}$	Collector cut-off current ( $V_{CB}=20V, I_E=0$ )			1	$\mu A$
$I_{EBO}$	Emitter cut-off current ( $V_{EB}=4V, I_C=0$ )			1	$\mu A$
$h_{FE}$	DC Current Gain ( $V_{CE}=3V, I_C=10mA$ )	82		390	
$V_{CE(sat)}$	Collector-emitter saturation voltage ( $I_C=100mA, I_B=10mA$ )			0.4	V
$C_{ob}$	Collector Output Capacitance ( $V_{CB}=10V, I_E=0, f=1.0MHz$ )		6		pF
$f_T$	Transition frequency ( $V_{CE}=5V, I_C=20mA, f=100MHz$ )		250		MHz

**$h_{FE}$  CLASSIFICATION**

Rank	P	Q	R
Range	82~180	120~270	180~390
Marking	CP	CQ	CR

**NPN Silicon Epitaxial Transistors**

**SOT-323**

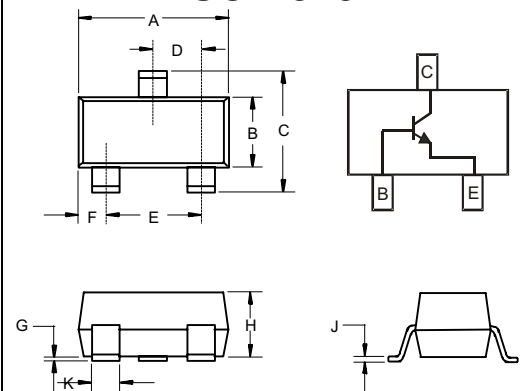

DIM	INCHES		MM		NOTE
	MIN	MAX	MIN	MAX	
A	.071	.087	1.80	2.20	
B	.045	.053	1.15	1.35	
C	.079	.087	2.00	2.20	
D	.026 Nominal		0.65Nominal		
E	.047	.055	1.20	1.40	
F	.012	.016	.30	.40	
G	.000	.004	.000	.100	
H	.035	.039	.90	1.00	
J	.004	.010	.100	.250	
K	.012	.016	.30	.40	

**Suggested Solder Pad Layout**

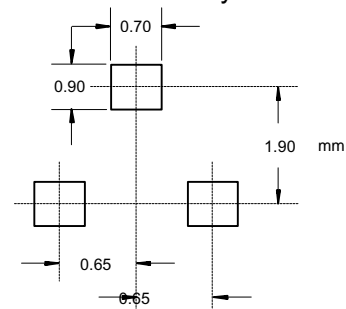

# 2SC4097-P/Q/R

● **Electrical characteristic curves**

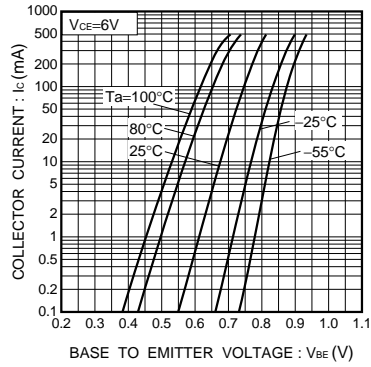

Fig.1 Grounded emitter propagation characteristics

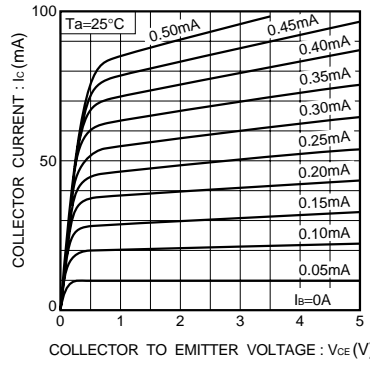

Fig.2 Grounded emitter output characteristics ( I )

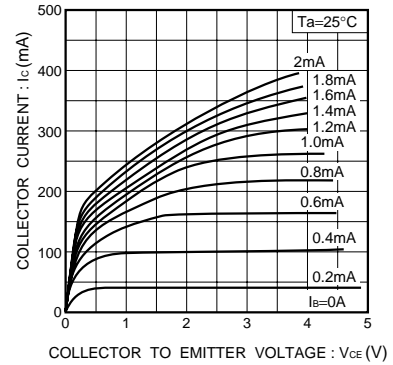

Fig.3 Grounded emitter output characteristics( II )

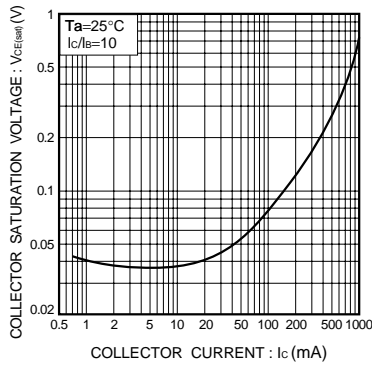

Fig.4 Collector-emitter saturation voltage vs. collector current

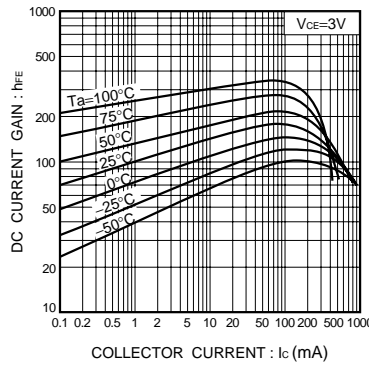

Fig.5 DC current gain vs. collector current

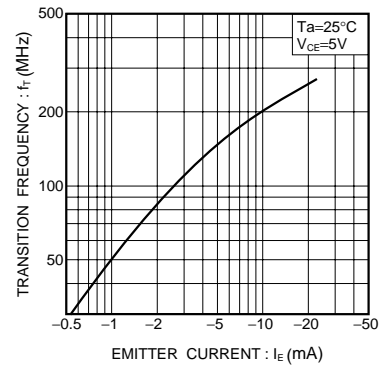

Fig. 6 Gain bandwidth product vs. emitter current

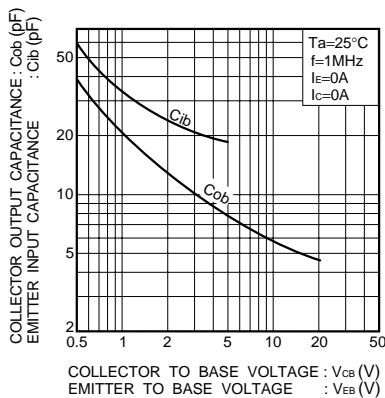

Fig.7 Collector output capacitance vs. collector-base voltage  
Emitter input capacitance vs. emitter-base voltage



Micro Commercial Components

### Ordering Information :

Device	Packing
Part Number-TP	Tape&Reel; 3Kpcs/Reel

**\*\*\*IMPORTANT NOTICE\*\*\***

**Micro Commercial Components Corp.** reserves the right to make changes without further notice to any product herein to make corrections, modifications, enhancements, improvements, or other changes. **Micro Commercial Components Corp.** does not assume any liability arising out of the application or use of any product described herein; neither does it convey any license under its patent rights, nor the rights of others. The user of products in such applications shall assume all risks of such use and will agree to hold **Micro Commercial Components Corp.** and all the companies whose products are represented on our website, harmless against all damages.

**\*\*\*LIFE SUPPORT\*\*\***

MCC's products are not authorized for use as critical components in life support devices or systems without the express written approval of Micro Commercial Components Corporation.

**\*\*\*CUSTOMER AWARENESS\*\*\***

Counterfeiting of semiconductor parts is a growing problem in the industry. Micro Commercial Components (MCC) is taking strong measures to protect ourselves and our customers from the proliferation of counterfeit parts. MCC strongly encourages customers to purchase MCC parts either directly from MCC or from Authorized MCC Distributors who are listed by country on our web page cited below. Products customers buy either from MCC directly or from Authorized MCC Distributors are genuine parts, have full traceability, meet MCC's quality standards for handling and storage. **MCC will not provide any warranty coverage or other assistance for parts bought from Unauthorized Sources.** MCC is committed to combat this global problem and encourage our customers to do their part in stopping this practice by buying direct or from authorized distributors.

[www.mccsemi.com](http://www.mccsemi.com)