

Surface Mount Schottky Power Rectifier

Pb-Free package is available

The Schottky Power Rectifier employs the Schottky Barrier principle with a barrier metal that produces optimal forward voltage drop–reverse current tradeoff. Ideally suited for low voltage, high frequency rectification, or as free wheeling and polarity protection diodes in surface mount applications where compact size and weight are critical to the system.

These state-of-the-art devices have the following features:

- Guardring for Stress Protection
- Very Low Forward Voltage (0.38 V Max @ 0.5 A, 25°C)
- 125°C Operating Junction Temperature
- Epoxy Meets UL94, VO at 1/8"
- Package Designed for Optimal Automated Board Assembly

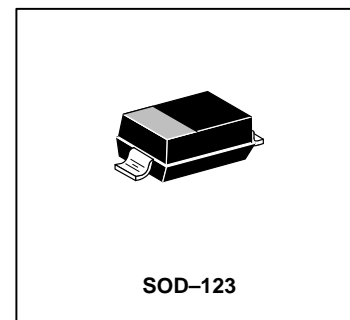

Mechanical Characteristics

- Reel Options: FDR0520T1G = 3,000 per 7" reel/8 mm tape.
FDR0520T3G = 10,000 per 13" reel/8 mm tape.
- Device Marking: B2
- Polarity Designator: Cathode Band
- Weight: 11.7 mg (approximately)
- Case: Epoxy, Molded
- Finish: All External Surfaces Corrosion Resistant and Terminal Leads are Readily Solderable
- Lead and Mounting Surface Temperature for Soldering Purposes: 260°C Max. for 10 Seconds

MAXIMUM RATINGS

Rating	Symbol	Value	Unit
Peak Repetitive Reverse Voltage Working Peak Reverse Voltage DC Blocking Voltage	V_{RRM} V_{RWM} V_R	20	Volts
Average Rectified Forward Current (Rated V_R) $T_L = 90$ C	$I_{F(AV)}$	0.5	Amps
Non-repetitive Peak Surge Current (Surge applied at rated load conditions halfwave, single phase, 60 Hz)	I_{FSM}	5.5	Amps
Storage Temperature	T_{stg}	-65 to +125	C
Operating Junction Temperature	T_J	-65 to +125	C
Voltage Rate of Change (Rated V_R)	dv/dt	1000	V/ μ s

THERMAL CHARACTERISTICS

Thermal Resistance — Junction to Ambient (1)	$R_{\theta JA}$	340	C/W
Thermal Resistance — Junction to Lead	$R_{\theta JL}$	150	C/W

ELECTRICAL CHARACTERISTICS

Maximum Instantaneous Forward Voltage (2) ($i_F = 0.1$ Amps) ($i_F = 0.5$ Amps)	V_F	$T_J = 25$ C	$T_J = 100$ C	Volts
		0.300 0.385	0.220 0.330	
Maximum Instantaneous Reverse Current (2) ($V_R = 10$ V) (Rated dc Voltage = 20 V)	I_R	$T_J = 25$ C	$T_J = 100$ C	mA
		75 μ A 250 μ A	5 mA 8 mA	

(1) FR-4 or FR-5 = 3.5 x 1.5 inches using the Motorola minimum recommended footprint.

(2) Pulse Test: Pulse Width = 300 μ s, Duty Cycle \leq 2%.

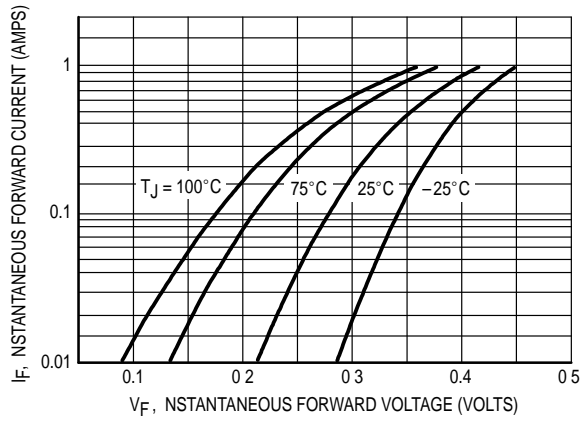

Figure 1. Typical Forward Voltage

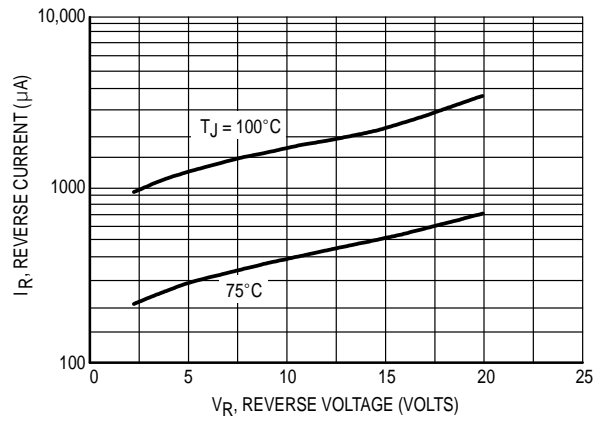

Figure 2. Typical Reverse Current

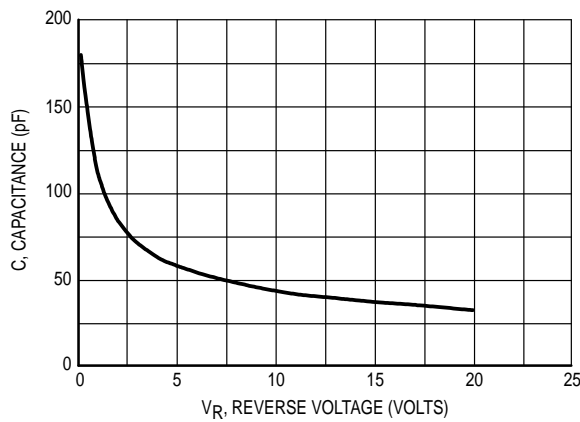

Figure 3. Typical Capacitance

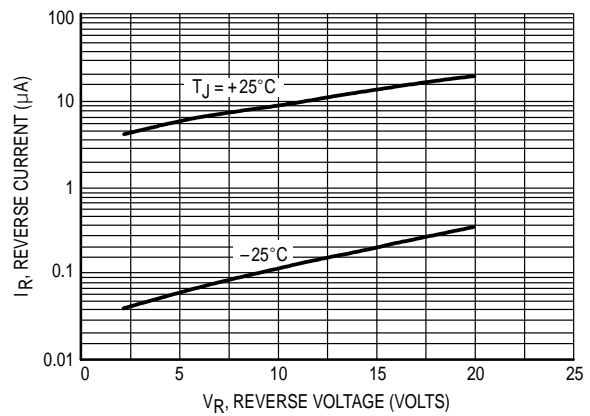

Figure 4. Typical Reverse Current

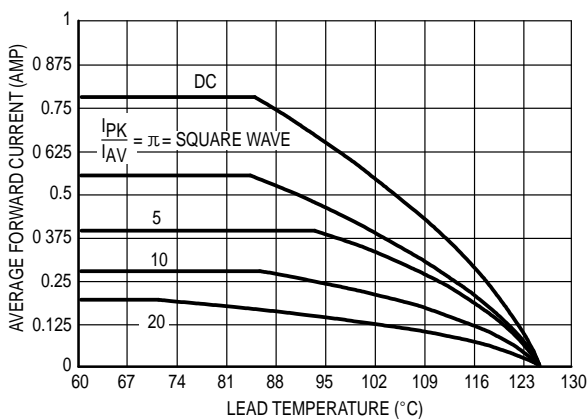

Figure 5. Current Derating (Lead)

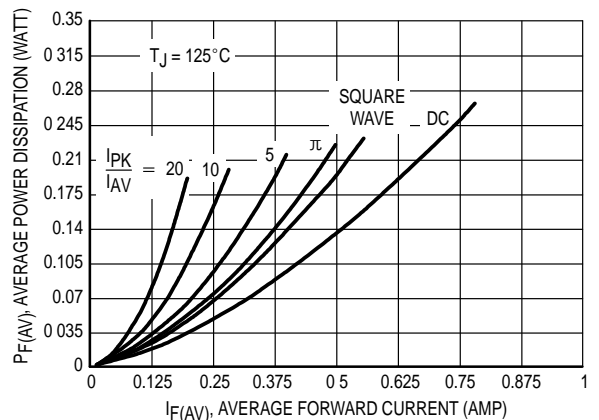
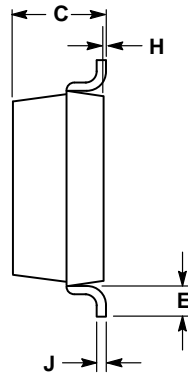
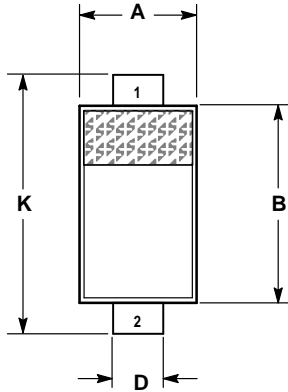

Figure 6. Power Dissipation

PACKAGE DIMENSIONS

SOD-123



NOTES:

1. DIMENSIONING AND TOLERANCING PER ANSI Y14.5M, 1982.
2. CONTROLLING DIMENSION: INCH.

DIM	INCHES		MILLIMETERS	
	MIN	MAX	MIN	MAX
A	0.055	0.071	1.40	1.80
B	0.100	0.112	2.55	2.85
C	0.037	0.053	0.95	1.35
D	0.020	0.028	0.50	0.70
E	0.004	—	0.25	—
H	0.000	0.004	0.00	0.10
J	—	0.006	—	0.15
K	0.140	0.152	3.55	3.85

STYLE 1:
PIN 1. CATHODE
2. ANODE

RECOMMENDED FOOTPRINT FOR SOD-123

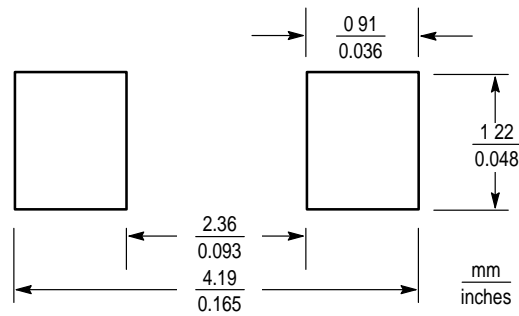

SOD-123