



CHENMKO ENTERPRISE CO.,LTD

Halogens free devices

SURFACE MOUNT

SCHOTTKY BARRIER DIODE

VOLTAGE 40 Volts CURRENT 0.1 Ampere

1SS388GP

APPLICATION

* Low current rectification and high speed switching

FEATURE

- * Extremely small surface mounting type. (SC-79/SOD-523)
- * $I_o=200mA$ guaranteed despite size
- * Low V_F . ($V_F=0.40V$ Typ. at 200mA)

CONSTRUCTION

* Silicon epitaxial planar



SC-79/SOD-523

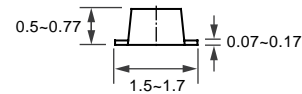
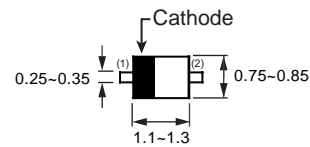

Dimensions in millimeters

SC-79/SOD-523

CIRCUIT



MAXIMUM RATINGS (At $T_A = 25^\circ C$ unless otherwise noted)

RATINGS	SYMBOL	1SS388GP	UNITS
Maximum Recurrent Peak Reverse Voltage	V_{RRM}	40	Volts
Maximum RMS Voltage	V_{RMS}	28	Volts
Maximum DC Blocking Voltage	V_{DC}	40	Volts
Maximum Average Forward Rectified Current	I_o	0.1	Amps
Peak Forward Surge Current at 8.3 mSec single half sine-wave	I_{FSM}	1.0	Amps
Typical Junction Capacitance between Terminal (Note 1)	C_J	2.0	pF
Maximum Operating Temperature Range	T_J	+125	$^\circ C$
Storage Temperature Range	T_{STG}	-40 to +125	$^\circ C$

ELECTRICAL CHARACTERISTICS (At $T_A = 25^\circ C$ unless otherwise noted)

CHARACTERISTICS	SYMBOL	1SS388GP			UNITS
Maximum Instantaneous Forward Voltage	V_F	0.28 at $I_F = 1mA$	0.36 at $I_F = 10mA$	0.60 at $I_F = 50mA$	Volts
Maximum Average Reverse Current at $V_R = 10V$	I_R	5.0			uAmps

NOTES : 1. Measured at 1.0 MHz and applied reverse voltage of 1.0 volts.
2. ESD sensitive product handling required.

2001-6

RATING CHARACTERISTIC CURVES (1SS388GP)

FIG. 1 - FORWARD CHARACTERISTICS

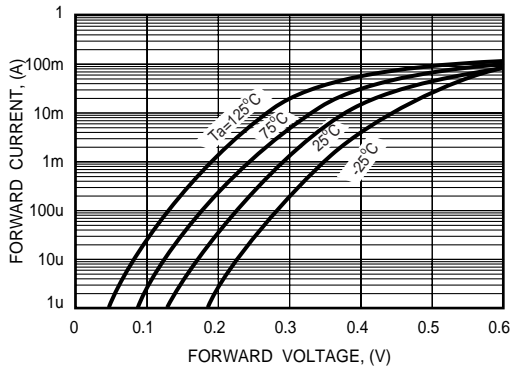

FIG. 2 - REVERSE CHARACTERISTICS

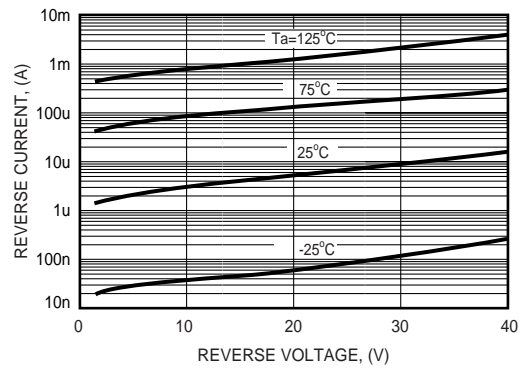

FIG. 3 - TYPICAL JUNCTION CAPACITANCE

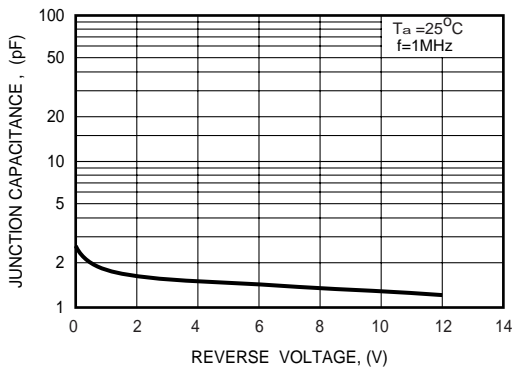

FIG. 4 - TYPICAL FORWARD CURRENT DERATING CURVE

